

RH 250.0

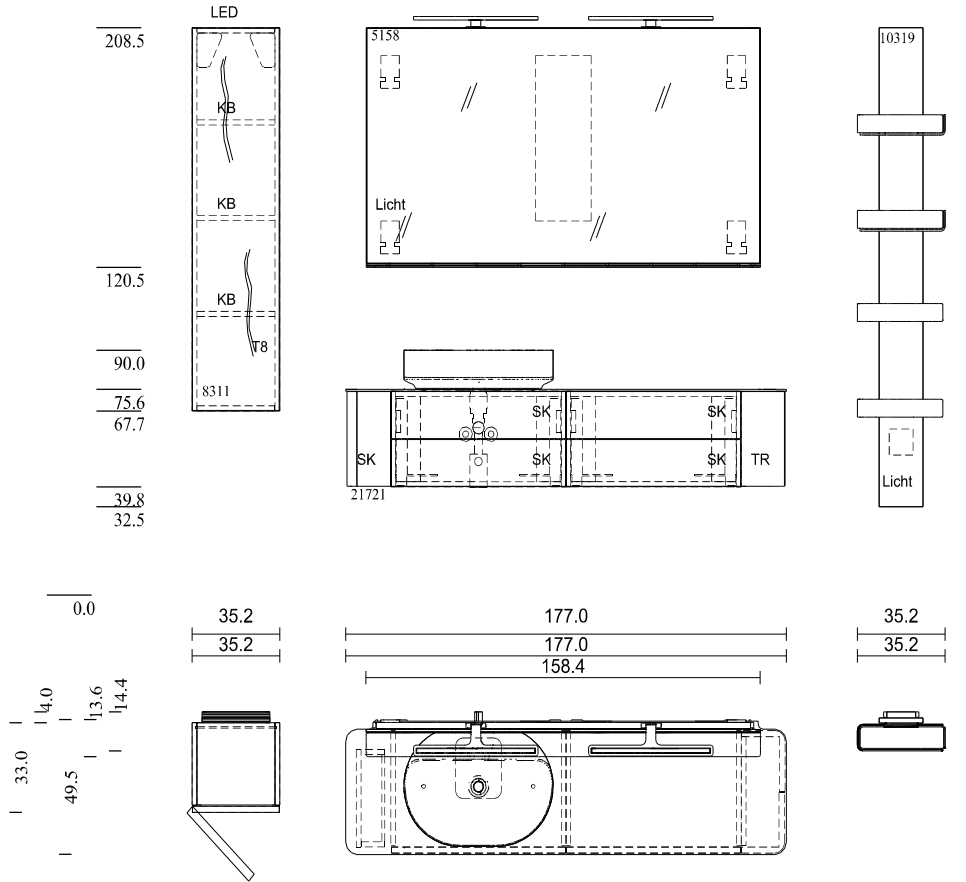

№836 Ra.  
№834 LED

2°394 Leuchte  
№51584 LED  
№282 Abschluss  
№291 Abschluss

№103194 LED  
№2119 FFB

| Rows                                  | A                          | B                                      | C |  |  |
|---------------------------------------|----------------------------|--|---|--|--|
| Front / unit carcass                  | Pure-white lacquer         | Unit carcass<br>Pure-white lacquer     |   |  |  |
| Accent                                | Oak natural - knotted      | Top cover surface<br>Ceramic Calacatta |   |  |  |
| Main washbasin unit / Rear wall panel | pure white lacquered glass | Washbasin type<br>Ceramic white, round |   |  |  |
|                                       |                            |  |   |  |  |

GEB1 [oj58 5m2w] 23.01.2023

|                     |     |
|---------------------|-----|
| Project number:     | 313 |
| commission / client |     |
| Customer:           |     |

RH 250.0

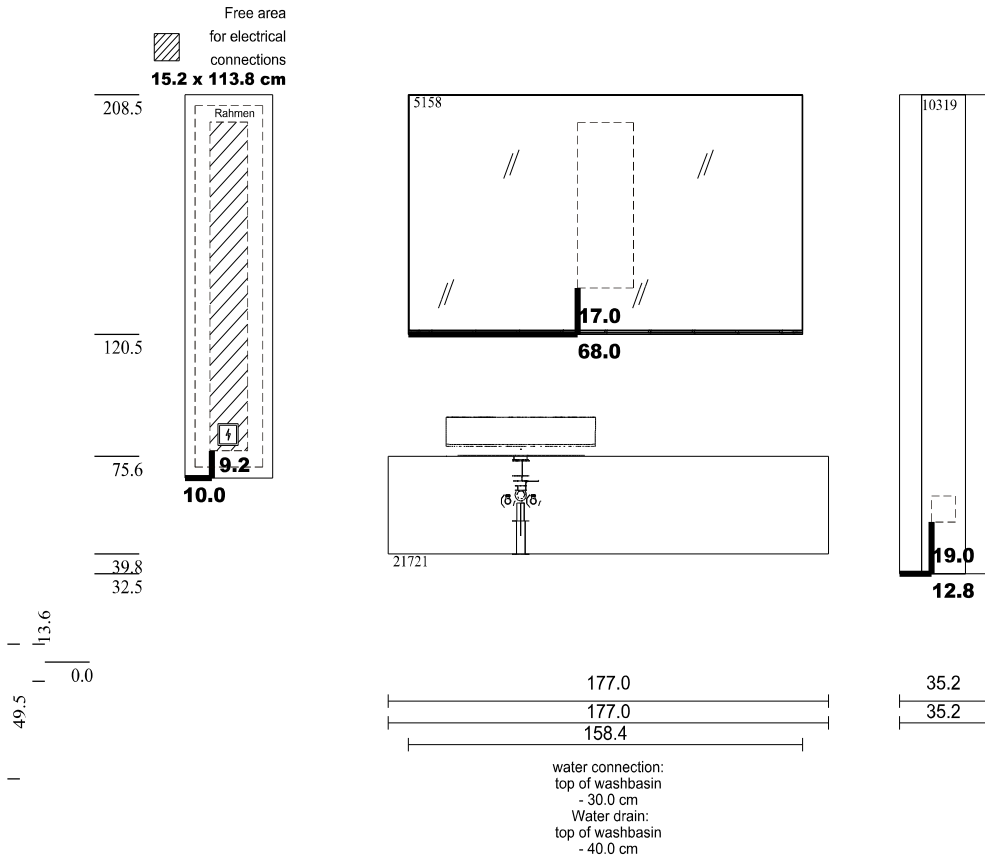

Rows

A

B

GEB1 [oj58 5m2w] 23.01.2023

|   |  |  |  |  |                        |
|---|--|--|--|--|------------------------|
| Front / unit carcass<br>Pure-white lacquer                          | Unit carcass<br>Pure-white lacquer     |  |  |  | Project number:<br>313 |
| Accent<br>Oak natural - knotted                                     | Top cover surface<br>Ceramic Calacatta |  |  |  | commission / client    |
| Main washbasin unit / Rear wall panel<br>pure white lacquered glass | Washbasin type<br>Ceramic white, round |  |  |  | Customer:              |
|   |  |  |  |  | Page 4 / 4             |